

Film Roller Blinds type Classic-Line with round casing



THE TASK

Glass of different shape and size is a characteristic of attractive architectural solutions, but also involves problems like the following:

- Excessive development of heat
- Glare and dazzle due to extreme light radiation

Sun blinds should not affect the architectural design of a building, i.e. they should be installed inside, so that the view of the outside world is unhindered.

Sun blinds should be easily accessible, most effective, unobtrusive and blend harmoniously into the design of the building.

The energy flow is to be reduced so that

- solar heat is kept out of the room and glare at the VDU workstation prevented
- visible light subdued, the k-value of the window improved and harmful ultraviolet radiation filtered-off

THE SOLUTION

MULTIFILM roller blinds are made of special metallised yet transparent film material. The film surface towards the window reflects up to 80 % of solar radiation through the glass into the open. The residual light transmitting the reflector film is diffuse, thus reducing the luminous intensity and avoiding glare and dazzle. Heat development is reduced as well.

The benefits of MULTIFILM roller blinds are

- very good protection against solar heat
- optimum protection against dazzle and glare and unhindered view into the open
- improved k-value
- plenty of scope for architectural design

MULTIFILM roller blinds allow unobtrusive indoor installation, with the round casing fitting well into the interior design of a room.

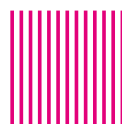

MULTIFILM®

Perfection for windows

Film Roller Blinds type Classic-Line with round casing

MULTIFILM roller blinds type - classic-line with round casing, the approved film roller blind for industry and trade, meets the most rigid requirements for design.

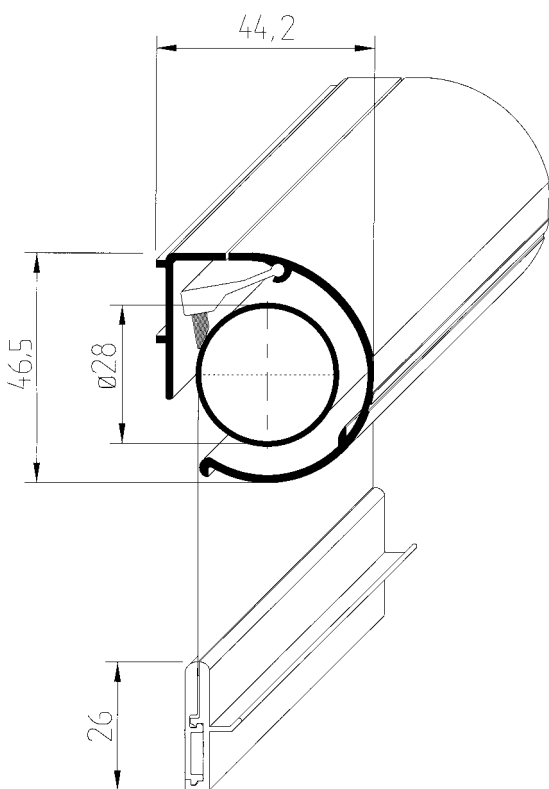

HERE ARE THE BENEFITS

- no bolts or screws that are visible
- max. drawing lengths of 2.600 mm
- discreet and attractive design of the casing
- choice of manual operation with chain, or electrical operation

DETAILS

Surface-embossed reflector film

The surface of the film is embossed in a way that

1. the reflector surface loses its mirror effect and fits properly into the facade of a building.
2. coherent light is diffuse when it enters the room. Reflections of daylight on (furnishing and equipment) are thus largely avoided.
3. increases the stability of the film and provides for a proper and smooth appearance from outside.

Cleaning brush

Special brush is integrated into the casing. It cleans the external surface of the film with every movement of the blind and ensure the effective-ness of the MULTIFILM product over a long period of time.

Side-guides

Various side-guides are available for optimum guidance of the reflector film. The side-guides are rounded at their bottom ends.

Bottom rail

Both ends of the bottom rail have plastic slides so that the rails will move silently in the side-guides.



MULTIFILM®

Perfection for windows
are available from: